

pH3에서도 녹슬지 않는 미니츄어 베어링

CASSTOP

キャストトップ

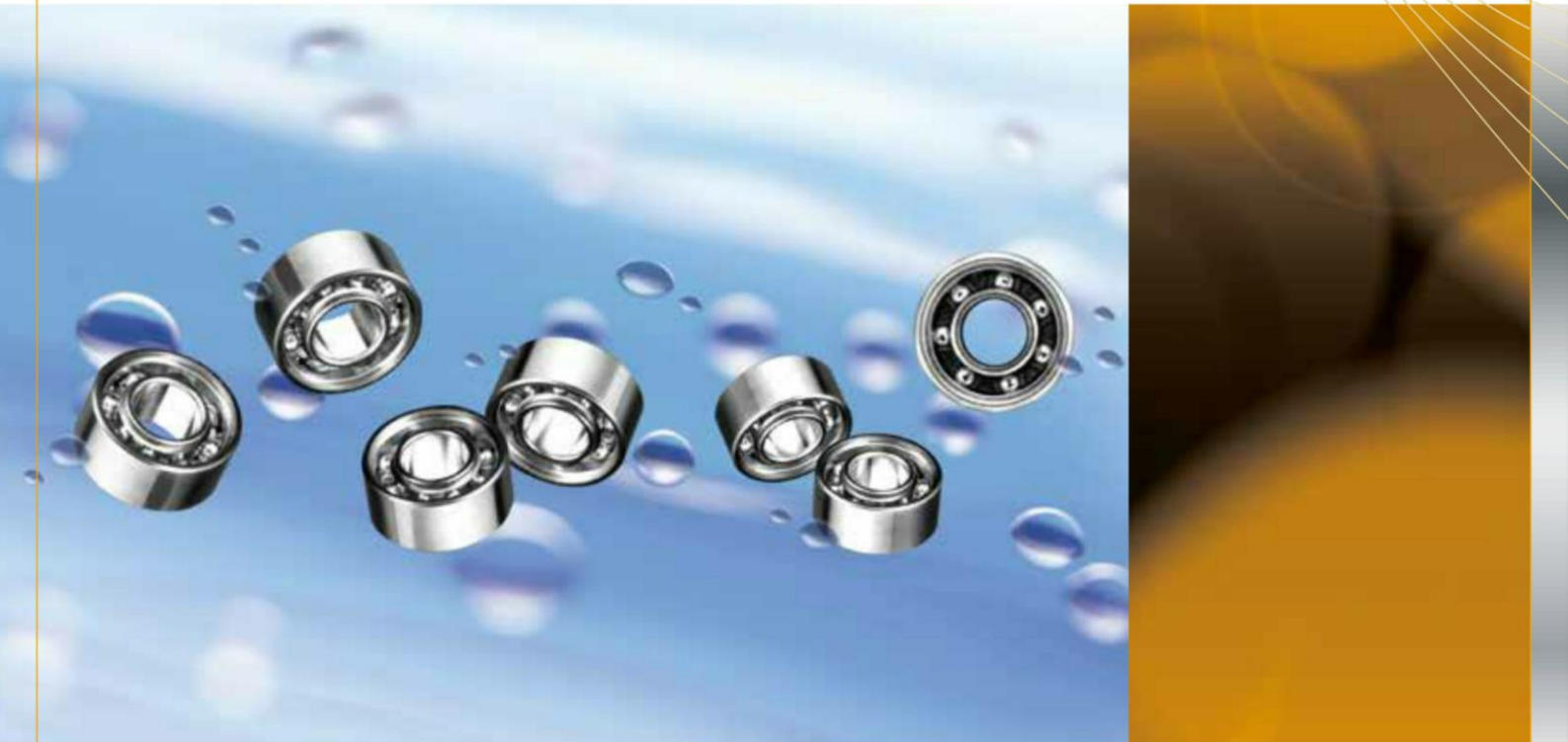

고내식 마텐자이트계 스테인리스 강철TBN-6H를 채용해 HRC59의 강도를 실현.
pH3~pH12의 약액을 다루는 가혹한 환경에서도 뛰어난 성능을 자랑합니다.



製品情報はコチラ

용도

- 염수환경에서 사용하는 기기(선박,항만의 각종 기기장치,낚시도구 등)
- 옥외에서 사용하는 기기
- 소독액 등을 사용하는 환경
- 특수환경용 팬 모터
- pH3~pH12의 약액을 사용하는 환경(의료기기,식품기계 등)

특장

- 적정성분(4화합성분X미량원소)의 첨가조정에서 만들어진 마텐자이트계 스테인리스 강철TBN-6H가 SUS440C를 능가하는 비약적인 내식성을 실현합니다.
- 독자적 열 처리기술로 강도:HRC59를 실현함과 동시에 베어링 내부제원을 최적화하는 것으로 SUS440C와 동등 이상의 내하성능을 자랑합니다.
- 산성, 알칼리성의 약액이나 염수, 빗물에 영향이 있는 환경 하에서도 여러 기능에 높은 신뢰성과 장수성 가동을 제공합니다.

CASSTOP내하중성

베어링내경^{φ7}

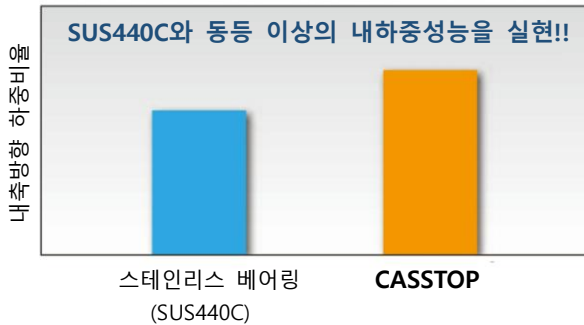

표준수치

단위:mm

품번	주요수치		
	내경	외경	폭
692A-H-X1ZZ	2	6	3
SMR63A2-H-X1ZZ	3	6	2.5
683A-H-X1ZZ		7	3
693A10-H-X1ZZ		8	4
623A3-H-X1ZZ		10	4
SMR74A2-H-X1ZZ	4	7	2.5
SMR84A1-H-X1ZZ		8	3
SMR104B-H-X1ZZ		10	4
694A1-H-X1ZZ		11	4
604A2-H-X1ZZ		12	4
624A5-H-X1ZZ		13	4
SMR85A12-H-X1ZZ	5	8	2.5
SMR95A5-H-X1ZZ		9	3
SMR105A2-H-X1ZZ		10	4
SMR115B-H-X1ZZ		11	4
685A3-H-X1ZZ		11	5
695A12-H-X1ZZ		13	4
605A1-H-XZZ		14	5
625A6-H-X1ZZ1		16	5
SMR106A4-H-X1ZZ		10	3
SMR126A4-H-X1ZZ		12	4
686A6-H-X1ZZ	6	13	5
696A6-H-X1ZZ		15	5
606-H-X1ZZ		17	6
626B-H-X1ZZ1		19	6
SMR117A-H-X1ZZ	7	11	3
SMR137B-H-X1ZZ		13	4
687A5-H-X1ZZ		14	5
697A2-H-X1ZZ		17	5
607B-H-X1ZZ		19	6
SMR128A5-H-X1ZZ	8	12	3.5
SMR148A2-H-X1ZZ		14	4
698-H-X1ZZ		19	6
608A35-H-X1ZZ1		22	7
689A3-H-X1ZZ		9	17
SMT1510A2-H-X1ZZ	10	15	4

TBN-6H 내식성 평가결과

나가노현 공업기술센터에서 실시

○ 염수분무테스트

조건: 염화나트륨(농도=50±5g/L)
ph=6.5~7.2
온도: 35°C±2°C 10일간

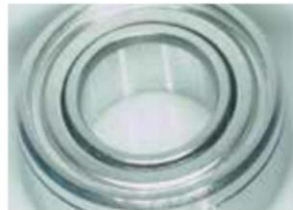

고내식베어링 CASSTOP

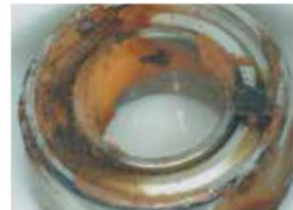

SUS440C



SUJ2

○ 캐스테스트

조건: 염화나트륨(농도=50±5g/L)
염화구리(II)
(농도=0.205±0.015g/L)용액
ph=3.1~3.3
온도: 35°C±2°C 10일간

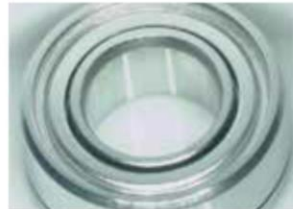

고내식베어링 CASSTOP



SUS440C



SUJ2

NSKマイクロプレジジョン株式会社



<http://www.nskmicro.co.jp/> (詳しくはホームページをご覧ください。)

本社 〒101-0054 東京都千代田区神田錦町3-17 廣瀬ビル6階
TEL.03-5283-7420 FAX.03-5259-0882
大阪営業所 〒540-6591 大阪府中央区大手前1-7-31 OMMビル5階
TEL.06-6942-0858 FAX.06-6941-9113
松本営業所 〒399-3303 長野県下伊那郡松川町元大島2953(松川工場内)
TEL.0265-48-6022 FAX.0265-48-6023

※内容については改良のため、予告なく変更することがありますのでご了承ください。

소형&고강성 미니츄어 포트 유닛

CROXPORT

クロクポート



자사제품 미니츄어 슬러스트 앵글러 베어링을 탑재하여
축방향 고강성과 메인터넌스 프리를 실현.
획기적인 소형,경량설계로 장치의 다운사이징을 가능하게합니다.



製品情報はコチラ

표준수치

- 축경3~8mm미니쥬어 볼 나사지지용 서포트 유닛입니다.
- 시장표준품보다 중량 60%감소(MSU-6C비교)를 달성하여 장치의 소형,경량화와 응답성 향상을 가능하게 합니다.
- 엄밀하게 예압을 관리한 자사제품 미니쥬어 스러스트 앵글러 볼 베어링 'CROXY'를 탑재하여 뛰어난 축방향 강성을 실현했습니다.
- 시장표준품과 비교하여 축심 높이는 같으며 축방향 하중성능은 전 형번에서 동등 이상으로 높습니다.
- 블록타입과 플랜지타입을 선택가능합니다.

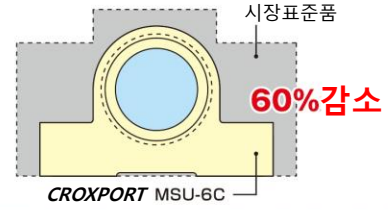

부품명	표준사양
하우징	블록타입 SMF재+저온흑색크롬도금 플랜지타입 SMF재+저온흑색크롬도금
누르개 너트	SUS303+흑산화처리
베어링	미니쥬어 스러스트 앵글러 볼 베어링 CROXY (클린 그리스(LG2))
블록 너트	SUS303+흑산화처리
스페이서	SUS303+흑산화처리
세트피스	C3604
6각홈고정나사	SUSXM7

표준수치

베어링호칭번호 예 MSU-5C

제품기호
호칭지수
형태기호

C고정축(블록) CS지지축(블록)
G고정축(플랜지) GS지지축(플랜지)

※제품은 록 너트, 스페이스 등 모두 세트로 되어있습니다.
※지지축 호칭지수는 베어링 내경과 다른 경우가 있으니 주의해주세요.
※각 지수는 예고 없이 변경될 가능성이 있으므로 양해부탁드립니다.

고정축 서포트 유닛 블록타입

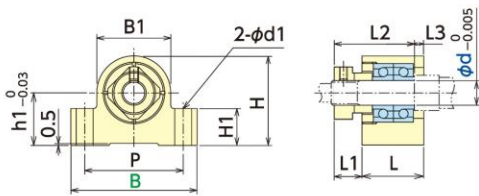

단위 : mm

베어링호칭번호	내장베어링	d	L	L1	L2	L3	B	H	h1	B1	H1	P	d1
MSU-3C	MTA03-08	3	12.5	5.5	16.5	1.5	24	14.5	9	11	5	18	3.5
MSU-4C	MTA04-11	4	14	5.5	17.5	2	27	17	10	14	6	21	3.5
MSU-5C	MTA05-13	5	15	5.5	18.5	2	30.5	19.5	11	17	6	23	4.5
MSU-6C	MTA06-15	6	17	7.5	22	2.5	35	22.5	13	19	8	26	5.5
MSU-8C	MTA08-19	8	20	9	26	3	41	29	17	24	12	32	5.5

지지축 서포트 유닛 블록타입

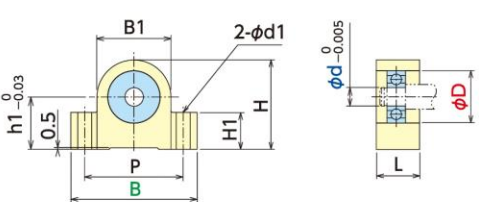

단위 : mm

베어링호칭번호	내장베어링	d	L	B	H	h1	B1	H1	P	d1	D
MSU-3CS	602ZZ	2	8	24	14.5	9	11	5	18	3.5	7
MSU-4CS	623ZZ	3	10	27	17	10	14	6	21	3.5	10
MSU-5CS	624ZZ	4	10	30.5	19.5	11	17	6	23	4.5	13
MSU-6CS	B6-113ZZ1	6	12	35	22.5	13	19	8	26	5.5	15
MSU-8CS	606ZZ	6	14	41	29	17	24	12	32	5.5	17

고정축 서포트 유닛 플랜지타입

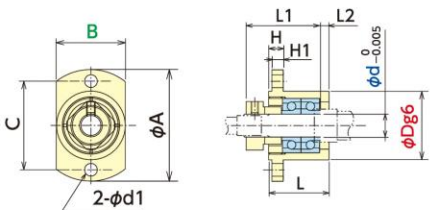

단위 : mm

베어링호칭번호	내장베어링	d	L	L1	L2	H	D	A	B	C	d1	H1
MSU-3G	MTA03-08	3	12.5	16.5	1.5	5	11	23	11	17	3.5	3
MSU-4G	MTA04-11	4	13.5	17.5	1.5	5	14	26	14	20	3.5	3
MSU-5G	MTA05-13	5	15	18.5	2	5	17	29	17	23	3.5	3
MSU-6G	MTA06-15	6	17	22	2.5	5	19	34	19	26	4.5	4
MSU-8G	MTA08-19	8	20	26	3	4	24	39	24	31	4.5	4

지지축 서포트 유닛 플랜지타입

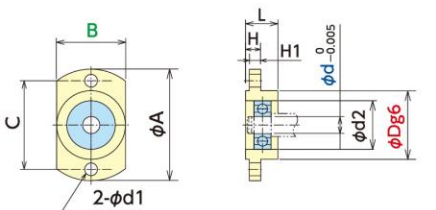

단위 : mm

베어링호칭번호	내장베어링	d	L	H	D	d2	A	B	C	d1	H1
MSU-3GS	602ZZ	2	8	5	11	7	23	11	17	3.5	3
MSU-4GS	623ZZ	3	10	5	14	10	26	14	20	3.5	3
MSU-5GS	624ZZ	4	10	5	17	13	29	17	23	3.5	3
MSU-6GS	B6-113ZZ1	6	10	5	19	15	34	19	26	4.5	4
MSU-8GS	606ZZ	6	10	4	24	17	39	24	31	4.5	4

NSKマイクロプレジジョン株式会社



<http://www.nskmicro.co.jp/> (詳しくはホームページをご覧ください。)

本社 〒101-0054 東京都千代田区神田錦町3-17 廣瀬ビル6階
TEL.03-5283-7420 FAX.03-5259-0882
大阪営業所 〒540-6591 大阪市中央区大手前1-7-31 OMMビル5階
TEL.06-6942-0858 FAX.06-6941-9113
松本営業所 〒399-3303 長野県下伊那郡松川町元大島2953(松川工場内)
TEL.0265-48-6022 FAX.0265-48-6023

※内容については改良のため、予告なく変更することがありますのでご了承ください。

고속·소형화를 지원하는 앵글러 베어링

CROXY
クロキシ-



이전의 깊은 홈 볼베어링(당사제)과 비교해 축 방향 강성을 약 3배까지 강화.
수직축 사용에 최적으로 장치의 소형화에도 이바지합니다.



製品情報はコチラ

ISC
MINIATURE BALL BEARINGS

용도

- 볼 나사 지지부
- 전동 작동 장치 지지부
- 로봇 암 지지용
- 서포트 유닛
- 반도체 제조 장치
- 감속기 등

특장

- 업계 첫, JIS규격69시리즈를 앵글러화 했습니다.
- 깊은 홈 베어링과 비교해 약 3배(당사비) 고강성을 실현하고 있습니다.
- 관리유지가 필요하지 않은 고성능 그리스 동봉+양 실드 사양입니다.
- 내 프레팅 그리스(EA7)과 클린 그리스(LG2)를 선택 가능합니다.
- 예압 조정한 조합으로 제공하므로 설치가 간단합니다.
(추천장려 고정 토크는 아래 표를 참고해주세요.)
- 정밀도 등급 P5가 표준입니다.
- 볼 나사 지지부나 장치 전체 사이즈다운에 이바지합니다.

이전의 깊은 홈 볼 베어링과 비교해 약 3배 축 방향 강성 (당사비)

축 방향 변위 비교(내경φ4mm)

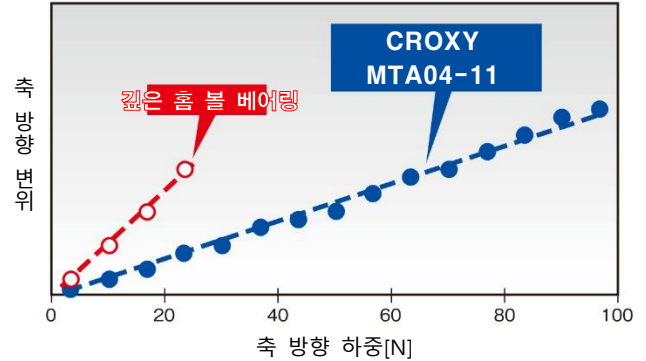

표준수치

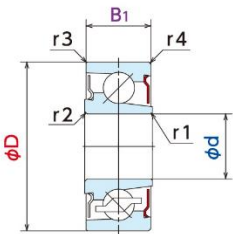

베어링 호칭 번호	주요수치(mm)							기본정격하중(N)								허용 축방향 하중 (N)	허용 회전수 (min-1)
	d	D	B1 외륜경	모따기(최소)				축 방향				레이디얼					
				r1	r2	r3	r4	동정격하중Ca	정정격하중Coa	동정격하중Cr	정정격하중Cor	동정격하중Ca	정정격하중Coa	동정격하중Cr	정정격하중Cor		
MTA02-06	2	6	3	0.1	0.1	0.04	0.1	555	470	450	360	288	245	92	75	87	26,000
MTA03-08	3	8	4	0.1	0.1	0.03	0.1	960	820	840	670	480	410	172	138	164	22,000
MTA04-11	4	11	4.5	0.2	0.2	0.1	0.2	1470	1250	1410	1130	745	635	282	227	464	17,000
MTA05-13	5	13	5	0.2	0.2	0.1	0.2	2090	1777	2170	1740	1080	915	440	355	549	16,000
MTA06-15	6	15	5.5	0.2	0.2	0.2	0.2	2760	2350	2950	2360	1390	1180	580	465	854	14,000
MTA08-19	8	19	6.5	0.2	0.2	0.3	0.3	4000	3400	4350	3480	2030	1730	870	700	1520	13,000

※허용 축 방향 하중: 초과 하중 또는 브리넬 압흔이 발생하는 하중

DB조합

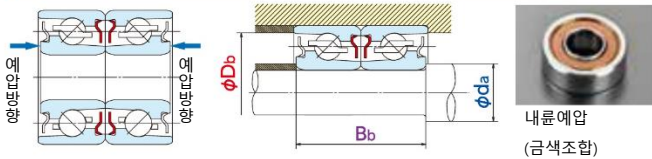

DF조합

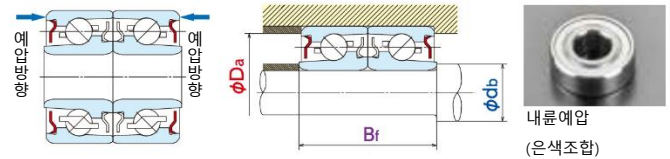

베어링 호칭 번호	조합										고정 토크(N·cm)	
	DB조합(mm)			DF조합(mm)			축 하중 강성 (N/μm)	레이디얼 강성 (N/μm)	세트재질 (참고) (g)	추천 장려 예압 (N)	DB조합	DF조합
	설치부 축φd _s 최소	하우징 φD _s 최대	조합 내륜부B _b	설치부 축φd _s 최소	하우징 φD _s 최대	조합 내륜부B _f						
MTA02-06	3.0	5.3	5.80	2.8	5.0	6.20	21	12	0.8	7	7	20
MTA03-08	4.4	7.2	7.72	3.9	6.7	8.28	28	16	1.7	12	7	50
MTA04-11	6.2	9.5	8.60	5.1	8.9	9.40	39	22	3.7	20	10	50
MTA05-13	7.2	11.3	9.60	6.1	10.8	10.40	52	29	5.5	34	25	50
MTA06-15	8.6	13.2	10.50	7.2	12.5	11.50	60	32	7.7	45	30	80
MTA08-19	11.4	16.8	12.36	9.4	15.8	13.64	76	39	14.0	70	60	80

NSK 마이크로プレジジョン株式会社

<http://www.nskmicro.co.jp/> (詳しくはホームページをご覧ください。)



本社 〒101-0054 東京都千代田区神田錦町3-17 廣瀬ビル6階
TEL.03-5283-7420 FAX.03-5259-0882
大阪営業所 〒540-6591 大阪市中央区大手前1-7-31 OMMビル5階
TEL.06-6942-0858 FAX.06-6941-9113
松本営業所 〒399-3303 長野県下伊那郡松川町元大島2953(松川工場内)
TEL.0265-48-6022 FAX.0265-48-6023

※内容については改良のため、予告なく変更することがありますのでご了承ください。



Challenges for Breakthrough Processing. Providing high precision and highly reliable jigs and tools with minimum delivery period.

ISC exceeds customer's expectations for the products, starting from the best choice of material for customer's needs and provides not only the best quality processing, but also in-house surface heat treatment.

Features

- High precision
- High reliability
- Minimum delivery period

Recommended applications

- Various jigs and tools
- General sample production

Process Contents

NC lathe processing

- Combined processing: Side drilling·Tap·Slitting (for bearing plastic retainer)
- Inner diameter : I/D ϕ 2.0mm·Depth 15mm
- Outer diameter : O/D ϕ 1.5mm X 20mm (Tolerance: w/in \pm 5 μ m)
- Special cutting tool : Minimum of ϕ 2.0mm (Super hard material)
- Housing shaft, Spacers, General sample processing, etc.

MC processing

- Drilling : Capable of processing up to ϕ 0.2mm, depth: 2mm
- Machining : End mill, Metal saw, Reamer
- Die casting
- Processing jigs and tools for machining centre

Cylindrical machining processing

- Tapered O/D : 1/800~1/4000
- Inner diameter : I/D ϕ 3.0mm·Depth 12mm (Tolerance: \pm 3 μ m)
- Hard chrome plating grinding
- Aluminum grinding

Miscellaneous processing

- Surface grinding
- Inner/Outer diameter cylindrical grinding
- Welding
- Surface treatment
- Heat treatment (Vacuum hardening·Sub zero treatment)

Material

SUJ-2·SKS·SKH·SK·SUS·FC·Super hard material·Aluminum·Brass·Resin, etc.

NSK Micro Precision Co., Ltd.

Head office/Sales Division Headquarters
No.1202, Nippon Building, 2-6-2 Otemachi, Chiyoda-ku, Tokyo 100-0004 Japan
Tel : +81-3-3270-2431 Fax : +81-3-3245-1372
Osaka Sales Office
No.301, TTN Minami-Shinmachi Building, 1-4-1 Minami-Shinmachi, Chuo-ku,
Osaka-shi, Osaka 540-0024 Japan
Tel : +81-6-6942-0858 Fax : +81-6-6941-9113
Matsumoto Sales Office
B210 Futabacho Bldg., 10-22 Futaba, Matsumoto-shi, Nagano 390-0833 Japan
Tel : +81-236-27-8680 Fax : +81-263-27-8933

<http://www.nskmicro.co.jp/>

※Contents may be revised without prior notice.

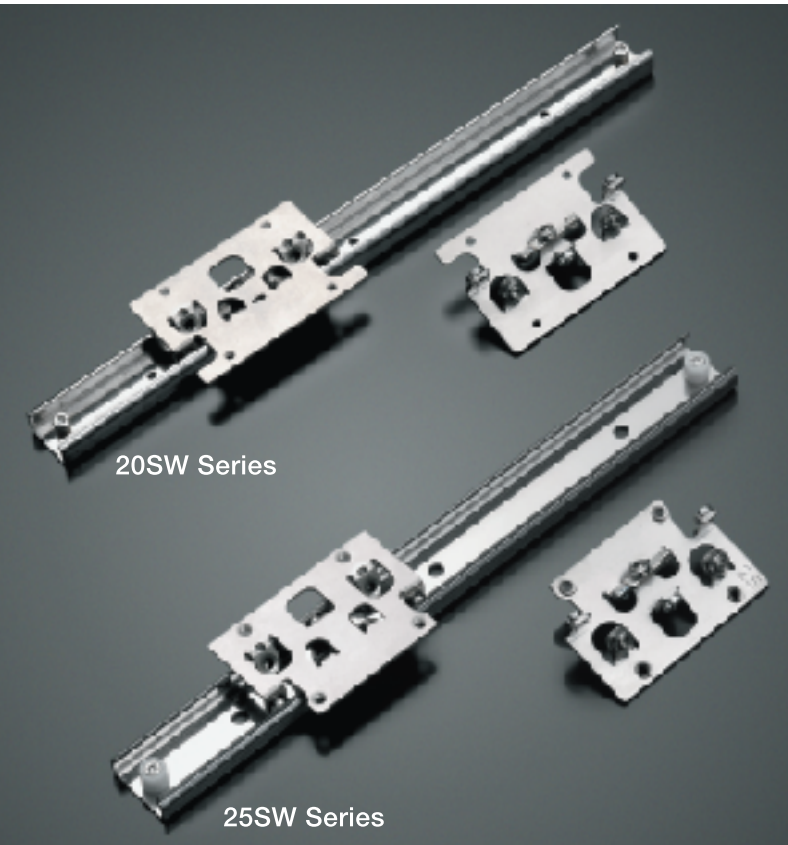

Liner Motion Products with High Precision Miniature Ball Bearings

Six pieces of miniature ball bearing contribute to the smoother performance without engagement. Non looseness is achieved by controlling the pre-load during the assembly process. Low cost with higher precision and simplified design is materialized by stainless rail and ultra high precision pressed parts (electroless nickel).

Features

- Uses six pieces of ultra high precision ball bearing.
- No looseness between rail and head by pre-loading design.
- Apply to sliding parts with lighter load.
- Smoother movement is achieved by rotating bearings.
- Simplified design for easier mounting to various machineries.
- Low cost is achieved by the simplified design.

Recommended application

- Monetary related instruments
- Various controlling / gearing instruments

★Standard Dimension Table (Stainless rail)

25SW Series

unit: mm

Item Number	Boundary dimensions		
	Rail Length (L)	Mobile Range	Fixing hole (n)
25SW160S	160	88	2
25SW240S	240	168	3
25SW320S	320	248	4
25SW400S	400	328	5
25SW480S	480	408	6
25SW560S	560	488	7
25SW640S	640	568	8
25SW720S	720	648	9
25SW800S	800	728	10
25SW880S	880	808	11
25SW960S	960	888	12
25SW1040S	1040	968	13
25SW1200S	1200	1128	15

20SW Series

20SW160SSN	160	84	2
20SW240SSN	240	164	3
20SW570SSN	570	500	7

Material

Rail: Stainless steel

Bearing: Stainless steel (double sealed)

Plate: Electroless nickel plating

Load direction	Pa	Pb	Pc	Pd
Static tolerance load (N)	50	100	200	100
Dynamic tolerance load (N)	10	20	80	30

Moment load can cause the looseness on this product due to its nature of design.

25SW Series

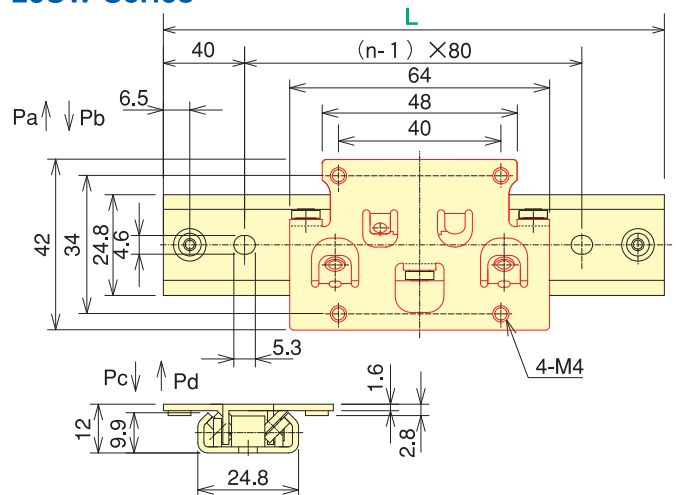

20SW Series

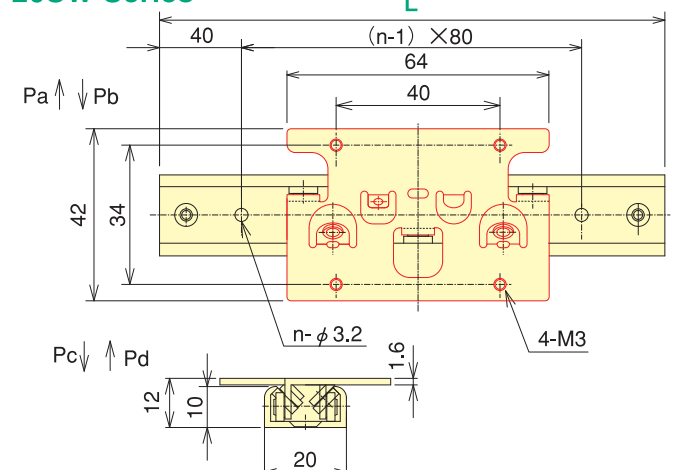

Endurance Test Data (level setting)

*Reference data

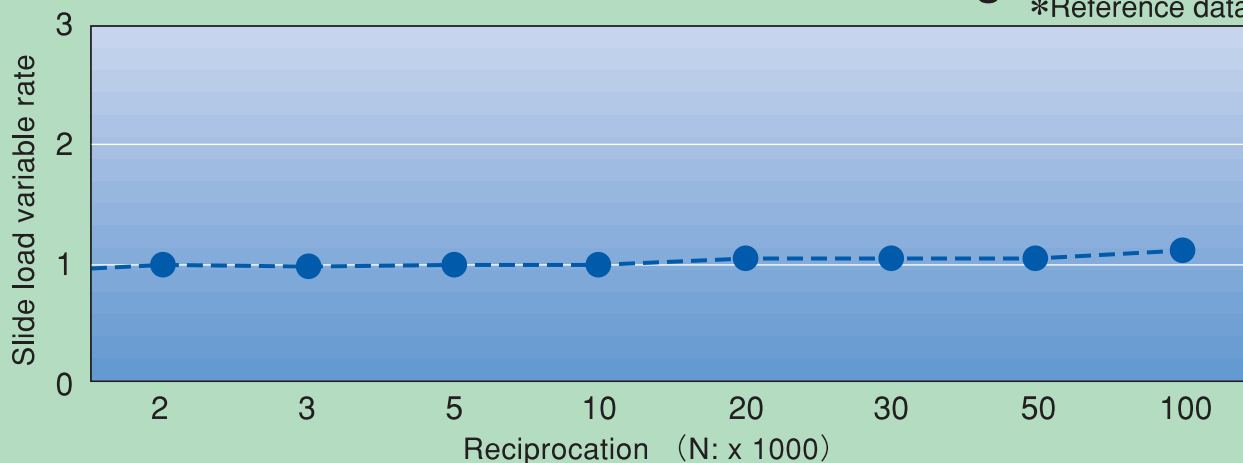

Testing Condition

Load : 30N
 Speed : 160mm/sec
 Lubrication : Coated

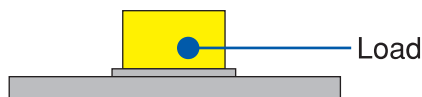

Slide load is stable after 100,000 times of reciprocation.

Rigidity Testing Data

*Reference data

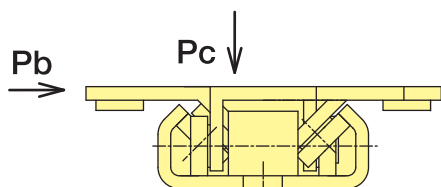
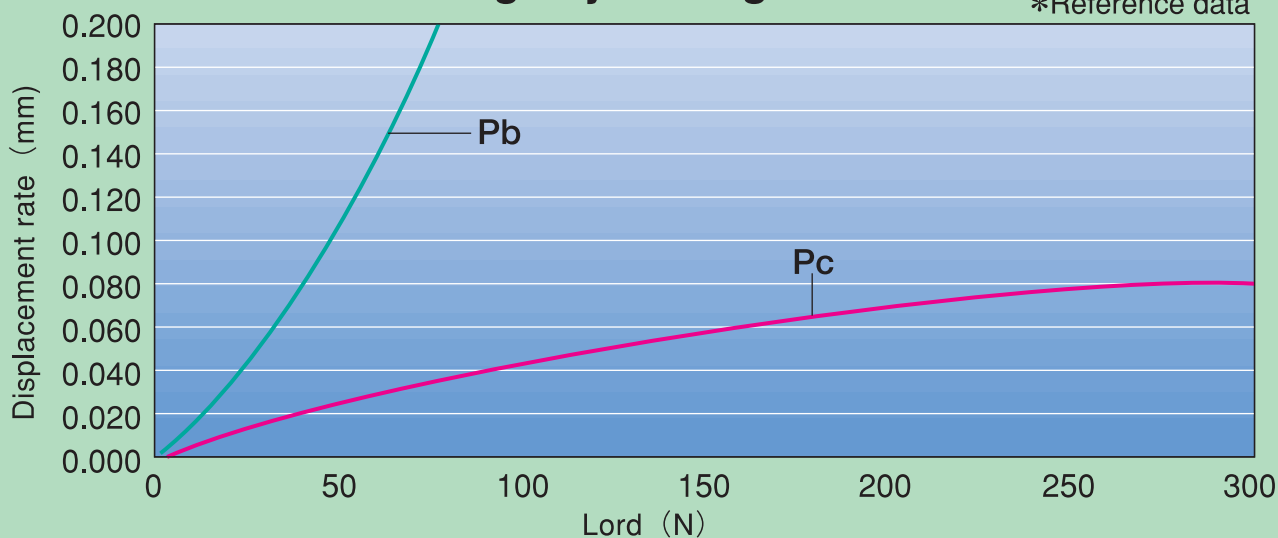

Rigidity

Due to its nature of the design, this product has more rigidity on Pc direction compared with Pb direction. The application for Pc direction is rather recommended.

NSK Micro Precision Co., Ltd.

Head office/Sales Division Headquarters
 No.1202, Nippon Building, 2-6-2 Otemachi, Chiyoda-ku, Tokyo 100-0004 Japan
 Tel : +81-3-3270-2431 Fax : +81-3-3245-1372
Osaka Sales Office
 301 Wakita-Tenmabashi Building, 2-13, Tenmabashi-Kyomachi,
 Chuo-ku, Osaka-shi, Osaka 540-0032 Japan
 Tel : +81-6-6942-0858 Fax : +81-6-6941-9113
Matsumoto Sales Office
 B210 Futabacho Bldg., 10-22 Futaba, Matsumoto-shi, Nagano 390-0833 Japan
 Tel : +81-263-27-8680 Fax : +81-263-27-8933

<http://www.nskmicro.co.jp/>

※Contents may be revised without prior notice.



ISC presents the series of shafted bearing that improves better mounting to unit parts.

ISC supports customer's needs for a precise fitting between shaft and bearing.

Features

- Delivers the products with ready-made form for quick mounting.
- Controls interference by adjusting a clearance of pushed-up bearing.
- Removal force between shaft and bearing is controlled by an adjustment of interference and push-up force

Recommended applications

- Carriage

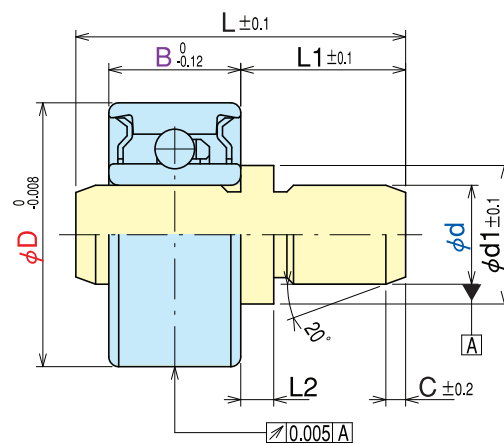
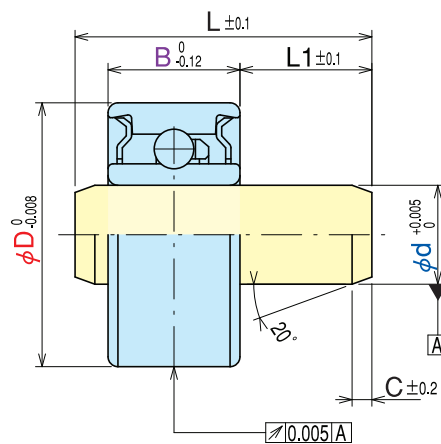

※Dimensions can be altered according to customer's request.

NSK Micro Precision Co., Ltd.

Head office/Sales Division Headquarters
 No.1202, Nippon Building, 2-6-2 Otemachi, Chiyoda-ku, Tokyo 100-0004 Japan
 Tel : +81-3-3270-2431 Fax : +81-3-3245-1372

Osaka Sales Office
 No.301, TTN Minami-Shinmachi Building, 1-4-1 Minami-Shinmachi, Chuo-ku,
 Osaka-shi, Osaka 540-0024 Japan
 Tel : +81-6-6942-0858 Fax : +81-6-6941-9113

Matsumoto Sales Office
 B210 Futabacho Bldg., 10-22 Futaba, Matsumoto-shi, Nagano 390-0833 Japan
 Tel : +81-263-27-8680 Fax : +81-263-27-8933

<http://www.nskmicro.co.jp/>

※Contents may be revised without prior notice.

Ultra High Speed, Low Vibration Dental Bearing

ISC dental bearing performs exceptionally as the critical part for dental hand piece in which super high precision and ultra high speed rotation are required.

Features

- 450,000min⁻¹ ~up to 500,000min⁻¹
- Higher anti-corrosion has been achieved with newly developed material (ES-1)
- Torlon cage sustains higher stability against autoclave.
- Available with ceramic balls

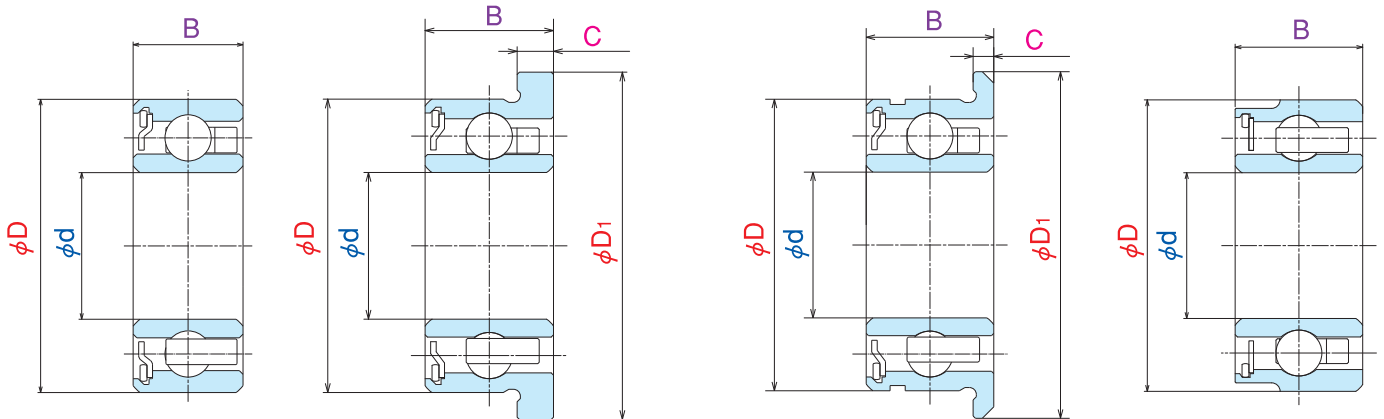
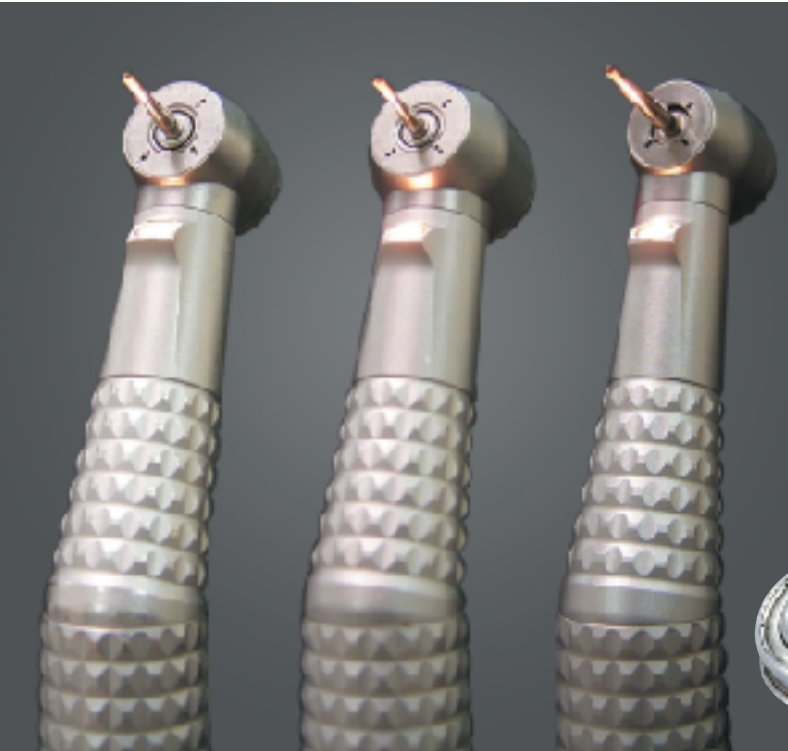

Standard Types

Customized Types

Standard

Bearing Number	Boundary Dimensions				
	d	D	B	D ₁	C
SR144X10Ah26T52YZS	3.175	6.350	2.779	-	-
SR144X12Ah26T52CZS	3.175	6.350	2.380	-	-
SFR144X10Ah26T52YZS	3.175	6.350	2.779	7.518	0.787
SFR144X12Ah26T52CZS	3.175	6.350	2.380	7.518	0.584

Customized

Bearing Number	Boundary Dimensions				
	d	D	B	D ₁	C
SFR144X010Ah26T52YZS	3.175	6.350	2.779	7.518	0.450
SR144X11h26T52CZS	3.175	6.350	2.779	-	-

*Please consult with ISC for special dimensions and materials

NSK Micro Precision Co., Ltd.

Head office/Sales Division Headquarters
No.1202, Nippon Building, 2-6-2 Otemachi, Chiyoda-ku, Tokyo 100-0004 Japan
Tel : +81-3-3270-2431 Fax : +81-3-3245-1372
Osaka Sales Office
301 Wakita-Tenmabashi Building, 2-13, Tenmabashi-Kyomachi,
Chuo-ku, Osaka-shi, Osaka 540-0032 Japan
Tel : +81-6-6942-0858 Fax : +81-6-6941-9113
Matsumoto Sales Office
B210 Futabacho Bldg., 10-22 Futaba, Matsumoto-shi, Nagano 390-0833 Japan
Tel : +81-263-27-8680 Fax : +81-263-27-8933

<http://www.nskmicro.co.jp/>

※Contents may be revised without prior notice.



Precise Plastic Molding for High Precision Bearing

ISC's plastic mold bearing is a miniature ball bearing with molded/press-fitted plastic on its outside face and is widely applicable to various machineries which requires precise guiding. Moreover, various combinations with bearings and screwed shafts are available according to customer's applications, including the combination with heat resistant/anti-static resins.

Features

- Standard version holds an excellent wear resistance and low noise level by using polyacetal resin on roller part.
- Outer diameter of plastic resin can be controlled up to $D \pm 0.015/0.01$ mm runout.
- Various designs on outside face are available according to the customer's request.
- Lays out the most suitable design with the best material choice according to customer's request on accuracy, durability and cost.

Recommended applications

- PPC
- Printer
- FAX

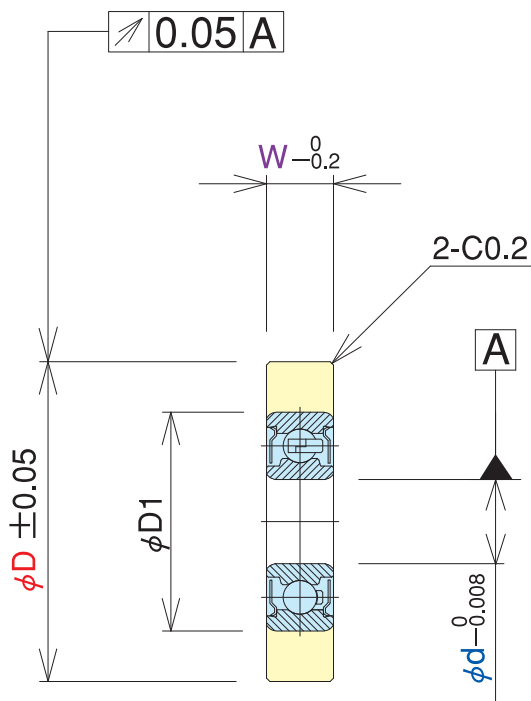

Unit: mm

Item Number	Boundary Dimensions				Nominal Bearing Number
	ϕd	ϕD	W	$\phi D1$	
13HFC301	3	13	4	8	693ZZ
14HFC301	3	14	4	8	693ZZ
15HFC301	3	15	4	8	693ZZ
15HFC401	4	15	4	9	684ZZ
16HFC401	4	16	4	9	684ZZ
19HFC401	4	19	5	13	624ZZ
17HFC501	5	17	4	13	695ZZ
18HFC501	5	18	4	13	695ZZ
19HFC501	5	19	4	13	695ZZ
16HFC601	6	16	4	12	MR126ZZ
17HFC601	6	17	4	12	MR126ZZ
18HFC601	6	18	4	12	MR126ZZ
19HFC601	6	19	4	12	MR126ZZ

※ Material : Polyacetal, standard grade/Color : Natural
 ※ Various dimensions are available upon request.

NSK Micro Precision Co., Ltd.

Head office/Sales Division Headquarters
 No.1202, Nippon Building, 2-6-2 Otemachi, Chiyoda-ku, Tokyo 100-0004 Japan
 Tel : +81-3-3270-2431 Fax : +81-3-3245-1372

Osaka Sales Office
 No.301, TTN Minami-Shinmachi Building, 1-4-1 Minami-Shinmachi, Chuo-ku, Osaka-shi, Osaka 540-0024 Japan
 Tel : +81-6-6942-0858 Fax : +81-6-6941-9113

Matsumoto Sales Office
 B210 Futabacho Bldg., 10-22 Futaba, Matsumoto-shi, Nagano 390-0833 Japan
 Tel : +81-263-27-8680 Fax : +81-263-27-8933

<http://www.nskmicro.co.jp/>

※ Contents may be revised without prior notice.